

## Facility Reopening Checklist

As businesses plan for and begin to reopen from previous COVID-19 closures, certain measures must be taken to ensure buildings are suitable for re-occupancy. With on-site staffing and human foot traffic significantly reduced or eliminated over the last few months, pest populations across the country were afforded a unique opportunity to infiltrate buildings undisturbed. In addition to adhering to all current CDC guidelines for reopening, Rose Pest Solutions also recommends facility owners complete the following checklist of essential tasks before building re-occupancy occurs:



### BUILDING GROUNDS

- 0 Ensure the grounds surrounding the facility are properly maintained, as overgrown vegetation can attract pests to the property
- 0 Install a gravel perimeter around the building to help discourage vegetation growth that could harbor pests
- 0 Eliminate any areas of standing water, as mosquitoes only need half an inch of water to breed
- 0 Ensure any dumpsters on-site have a closeable lid and are located as far away from the building as possible



### BUILDING EXTERIOR

- 0 Seal any cracks or gaps on the exterior of the building, paying close attention to areas where pipes and utilities enter
- 0 Ensure gutters are free of debris and be sure to direct water away from the building through properly functioning downspouts to prevent water collection
- 0 Replace exterior lights with sodium vapor bulbs as these are less attractive to pests
- 0 Install door sweeps on exterior doors and repair any screens to prevent pests from gaining entry
- 0 Conduct an inspection of the building, paying close attention to any dark or damp areas as these are particularly attractive to pests

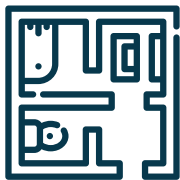

### BUILDING INTERIOR

- 0 Be on the lookout for any signs of damage to boxes and bags in storage areas as pests may have gained entry
- 0 Properly store or dispose of empty containers, as these can serve as harborage sites for pests
- 0 Ensure there is no condensation buildup on any equipment or appliances that could accumulate moisture and attract pests
- 0 Inspect under sinks for areas of moisture and repair any leaky pipes or faucets
- 0 When unpacking new inventory or receiving shipments, carefully inspect all items and packaging for any signs of damage
- 0 Monitor for signs of various infestations, including droppings, gnaw marks, nests, debris and actual pests themselves
- 0 Work with Rose Pest Solutions to implement an Integrated Pest Management plan (IPM) specific to your building